

OPLA' FOLDING +39

ISTRUZIONI DI MONTAGGIO ASSEMBLY INSTRUCTIONS

MODELLI:

MODELS:

411/39.1700.25 F OPLÀ +39 - CABINET 450 / 1000 mm

411/39.1720.25 F OPLÀ +39 - CABINET 1000 / 1200 mm

CONTENUTO DELLA CONFEZIONE INCLUDED IN THE PACKAGING

- GUIDE - SLIDES
- STAFFA - BRACKET (x2)
- ASTA (SOLO 411/39.1720.25 F) - BAR (ONLY 411/39.1720.25 F)

SACCHETTO ACCESSORI 1
ACCESSORIES 1

- A. Chiave esa. n.5 - n.5 Allen key
- B. Chiave esa. n.4 - n.4 Allen key
- C. Molla - Spring (x2)
- D. Ammortizzatore - Dumper (x2)
- E. Bussola M6 - Bush M6 (x12)
- F. Rondella - Washer (x10)
- G. Vite TCCE M5x6 - M5x6 SHCS screw (x6)
- H. Vite TCCE M6x12 - M6x12 SHCS screw (x12)

SACCHETTO ACCESSORI 2 (SOLO 411/39.1720.25 F)
ACCESSORIES 2 (ONLY 411/39.1720.25 F)

1. Vite TPS M5x12 - M5x12 tapered screw (x2)

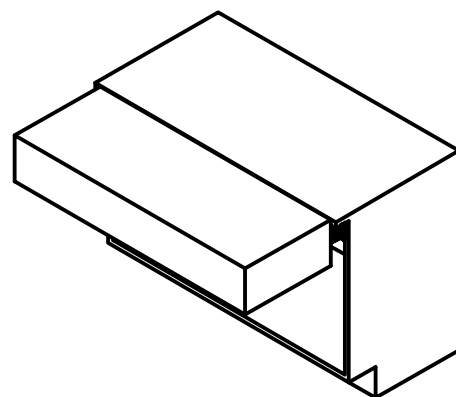

DIMENSIONI GENERALI - GENERAL SIZES

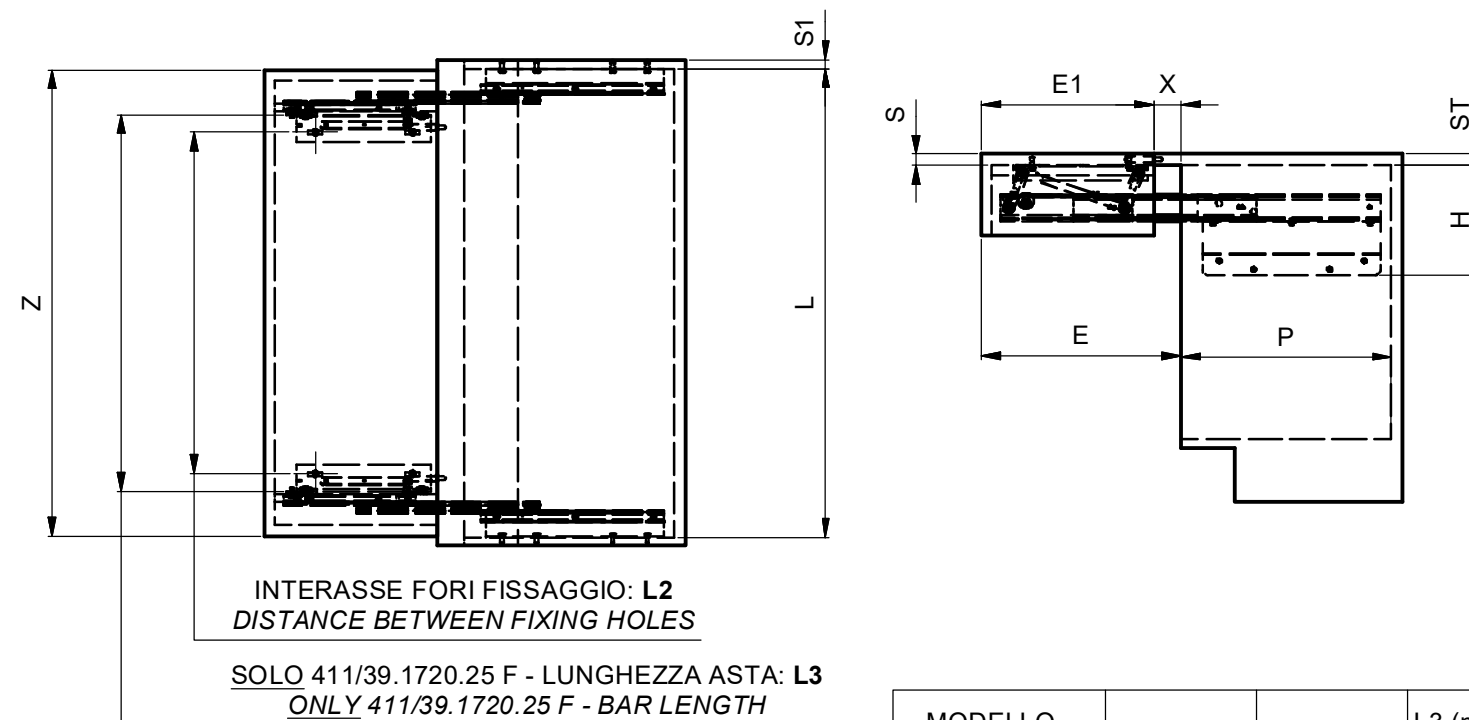

MODELLO - MODEL	L1 (mm)	L2 (mm)	L3 (mm) +/- 0.20 mm
411/39.1700.25	410/970	L1-235.5	L1-171.5
411/39.1720.25	960/1170	L1-235.5	L1-171.5

DIMENSIONE - DIMENSION	SIMBOLO - SYMBOL	mm
ALTEZZA - HIGHT	H	MIN: 205
PROFONDITA' - DEPTH	P	MIN: 390
LARGHEZZA - WIDTH	L	MIN/MAX: 410/1170
SPESSORE PIANO - TOP THICKNESS	S	MIN/MAX: 16/25
SPESSORE SPALLE - SIDE THICKNESS	S1	MIN/MAX: 15-20
SPESSORE TOP - TOP THICKNESS	ST	MIN/MAX: 16-25
LARGHEZZA PIANI - TOP WIDTH	Z	L - 5
SPORGENZA - PROTRUSION	X	-
APERTURA PIANI - TOP OPENING	E	370
LUNGHEZZA PIANO - TOP LENGTH	E1	E-X

POSIZIONE FORI - HOLES POSITION

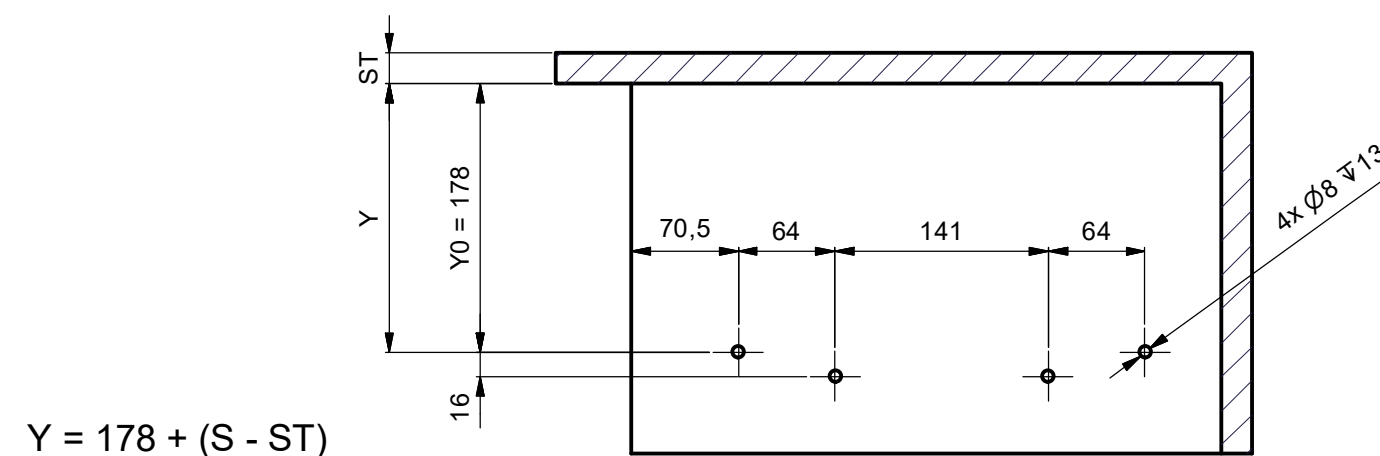

MONTAGGIO MECCANISMO ASSEMBLY OF MECHANISM

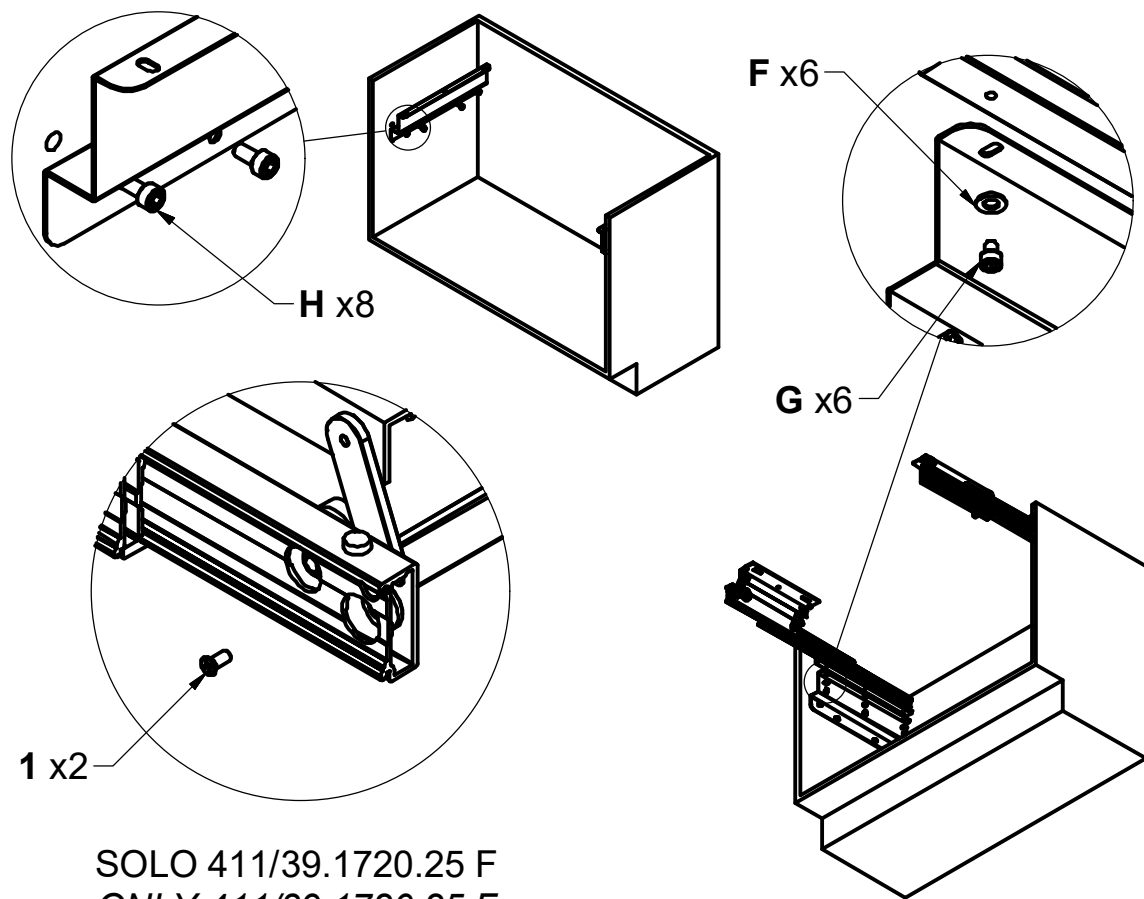

SOLO 411/39.1720.25 F
ONLY 411/39.1720.25 F

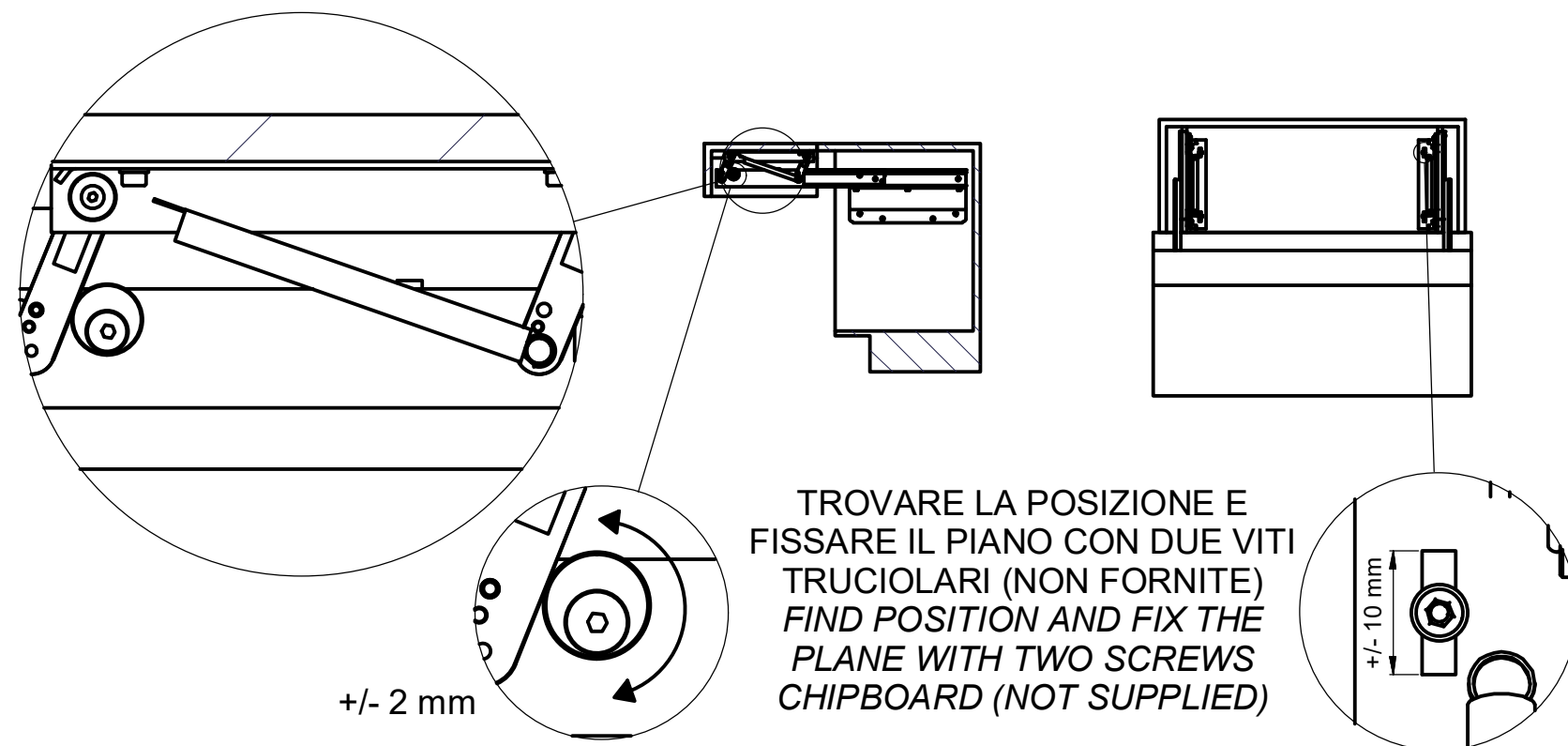

DIMENSIONE PIANO - TOP SIZE

